

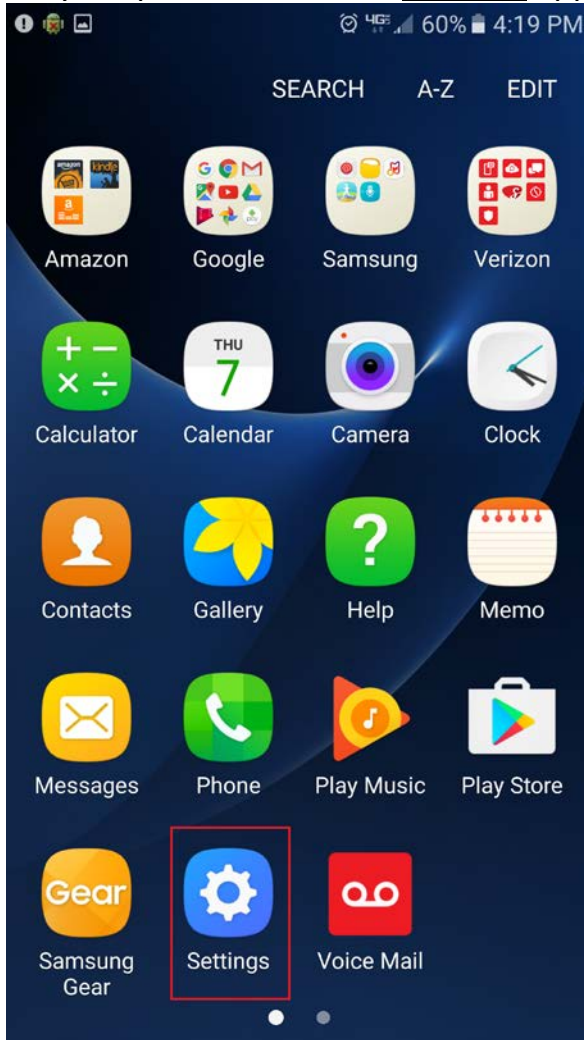

## Twin Lakes Android Email Setup – IMAP Option

1. On your phone locate the **Settings** application.



2. Once in the Settings application, locate the **Account tab** and click it.

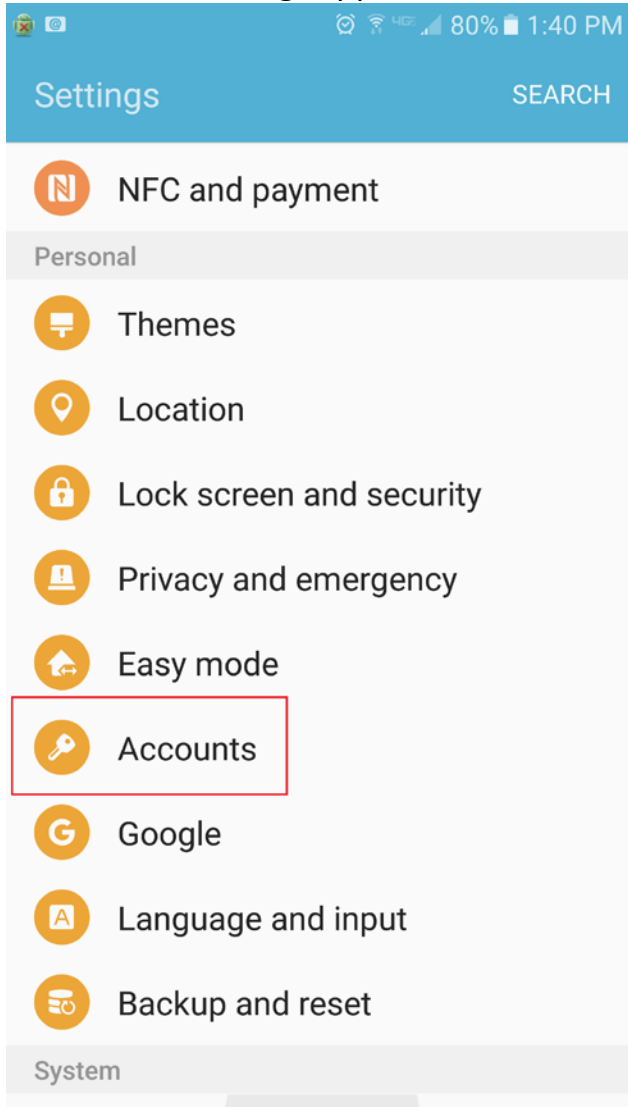

3. Next, Click Add account.

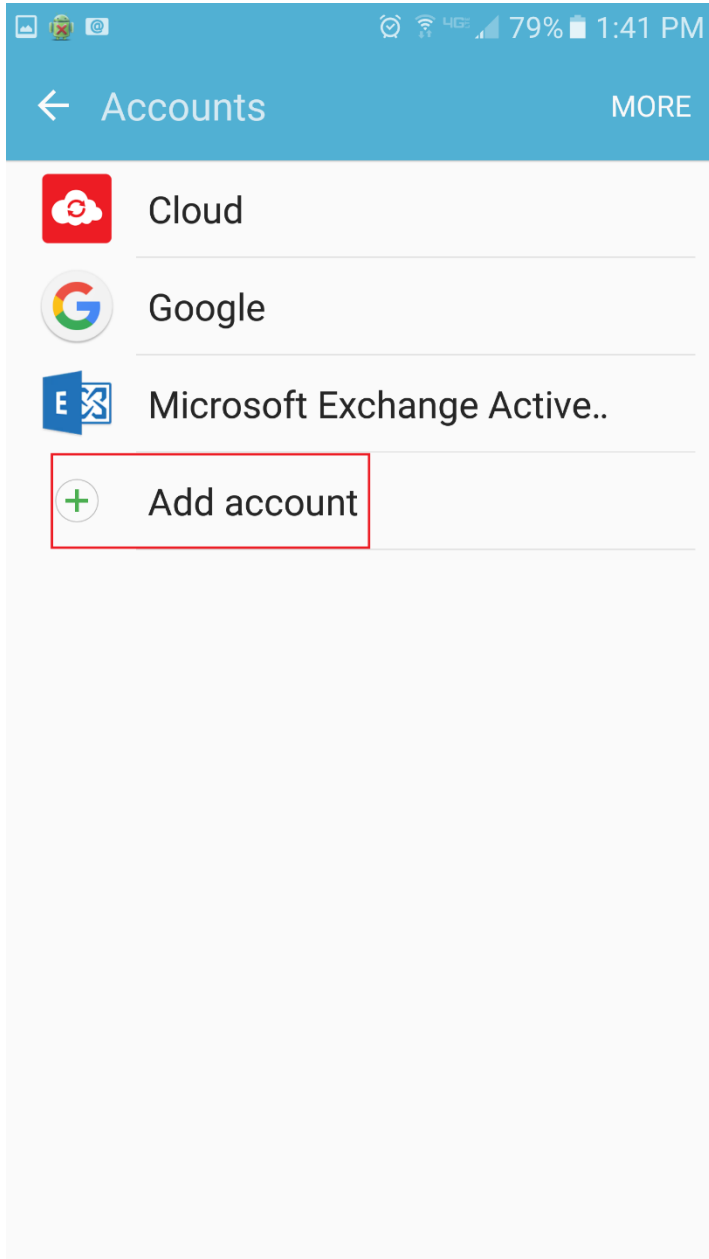

4. Once here click **Email**.

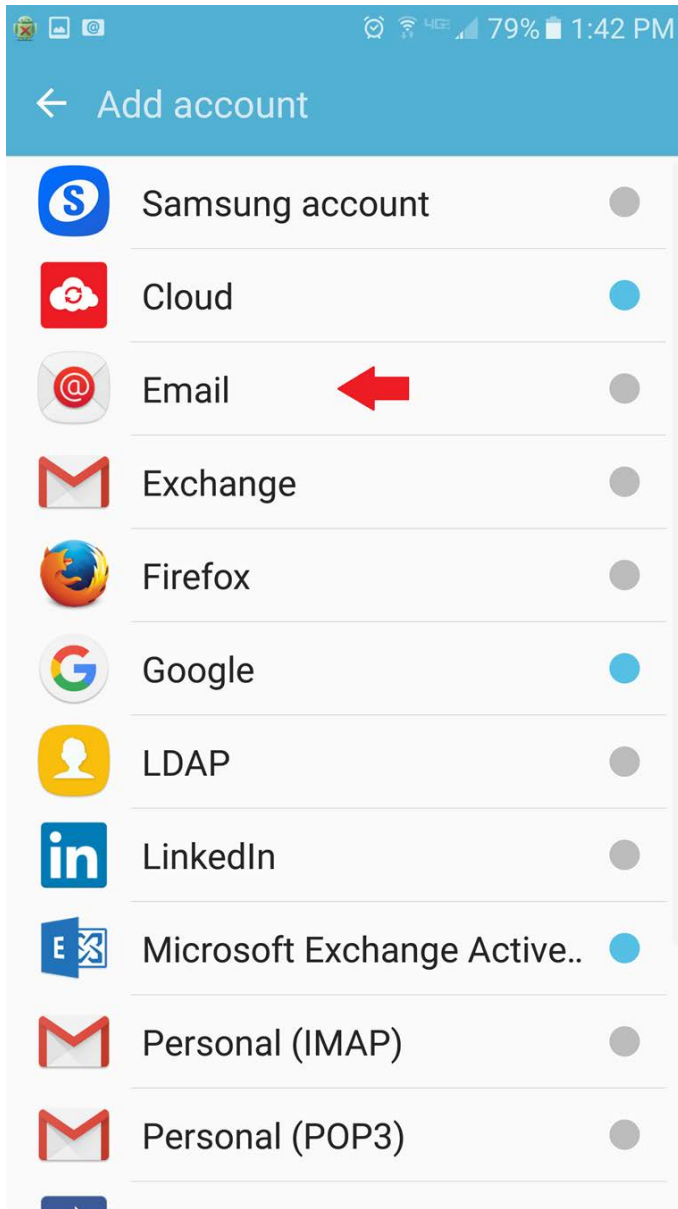

5. Once email is clicked, **enter** in your **Twin Lakes Email** and **password** then click Sign in.

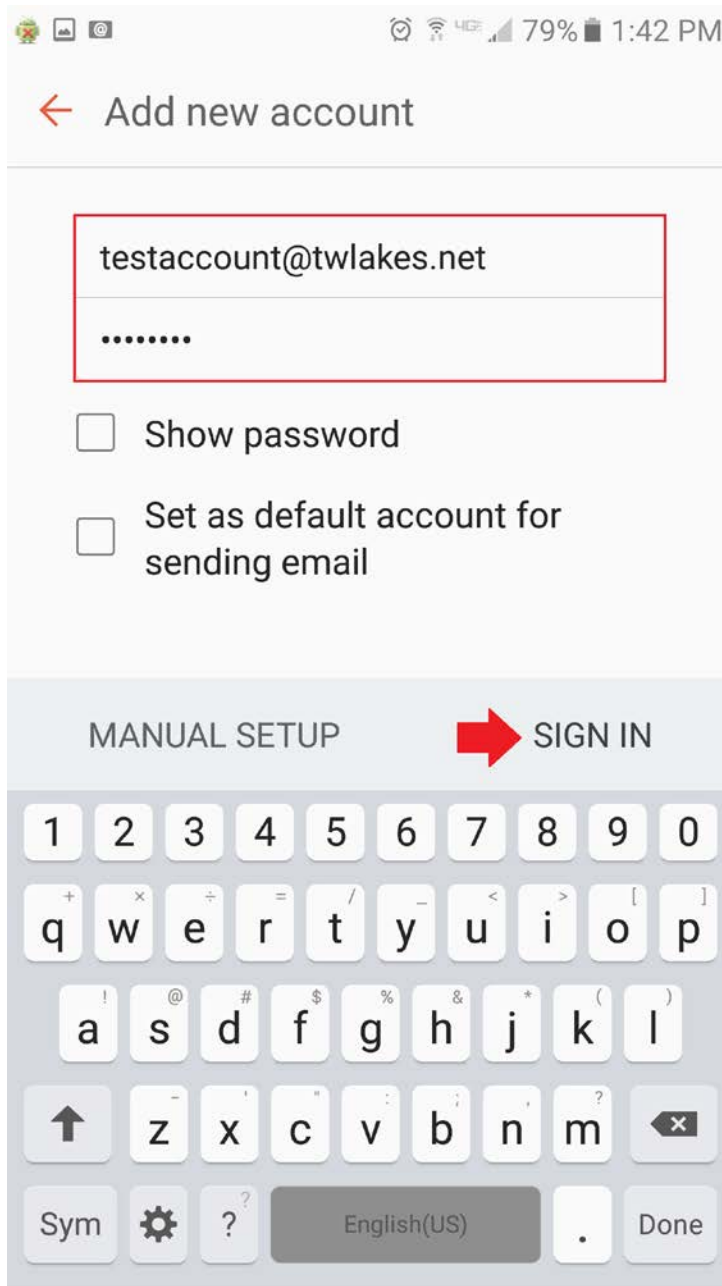

6. After this you need to select **IMAP Account.**

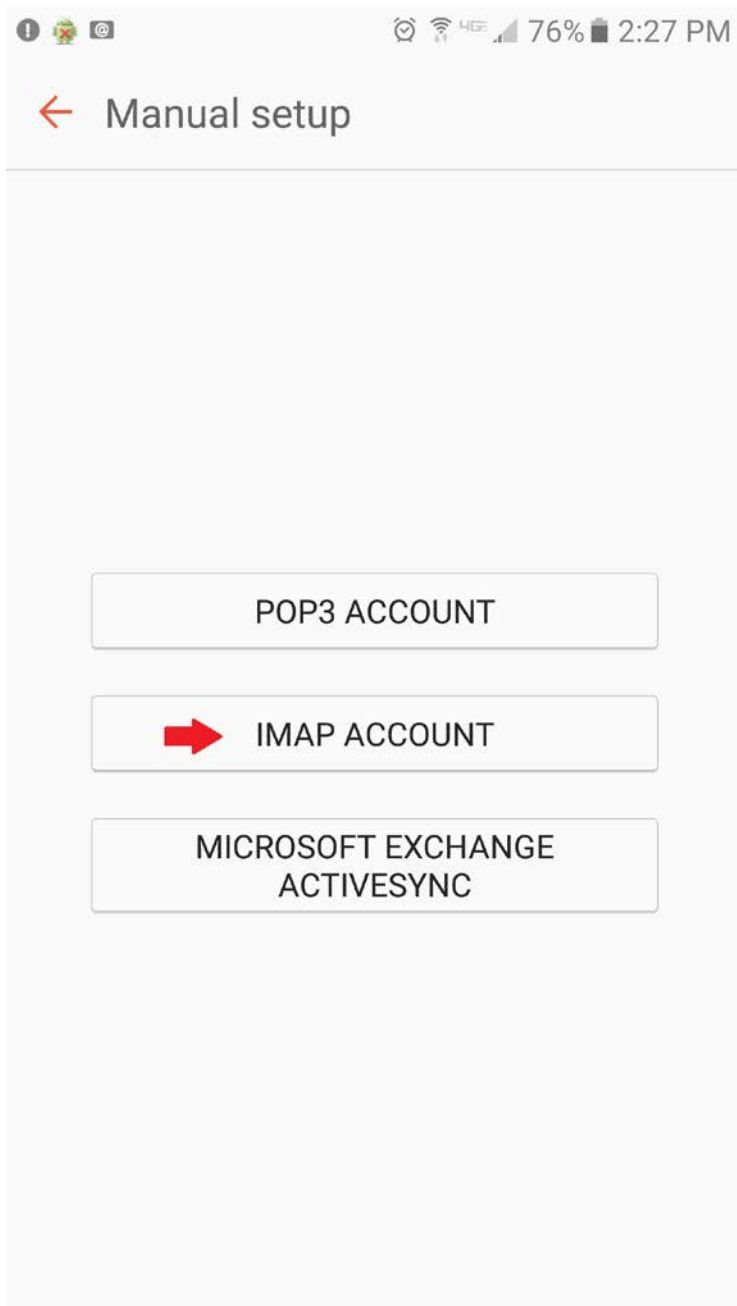

7. Next you are going to want to **enter** in your **Email, Username** (For Example testaccount), **Password**, and **change** the **IMAP Server** to **mail.twlakes.net**

The screenshot shows a mobile application interface for manual email setup. At the top, there is a status bar with icons for notifications, cellular signal, Wi-Fi, and battery level (75%) at 2:45 PM. Below the status bar is a header with a back arrow and the text "Manual setup". The main content area is divided into sections. The first section contains three input fields: "Email address" with the value "testaccount@twlakes.net", "User name" with the value "testaccount", and "Password" with a masked value of seven dots. Below these fields is a checkbox labeled "Show password" which is currently unchecked. The second section is titled "Incoming server" and contains three fields: "IMAP server" with the value "mail.twlakes.net" (circled in red), "Security type" with a dropdown menu set to "None", and "Port" with the value "143". Below these fields is a partially visible field for "IMAP path prefix" with the value "Optional". At the bottom right of the screen is a "SIGN IN" button.

Manual setup

Email address  
testaccount@twlakes.net

User name  
testaccount

Password  
.....

Show password

Incoming server

IMAP server  
mail.twlakes.net

Security type  
None ▼

Port  
143

IMAP path prefix  
Optional

SIGN IN

8. Then, you will **enter** in **smtp.twlakes.net**. Followed by your **Username**. Then click **Sign in**.

! 🌐 📷 📱 74% 2:46 PM

← Manual setup

---

Port  
143

---

IMAP path prefix  
Optional

---

Outgoing server

SMTP server  
mail.twlakes.net

---

Security type  
None ▼

Port  
587

---

Authentication required before sending emails

User name  
testaccount

---

**SIGN IN**



9. Next put in your desired **Sync schedule** and **period schedule**. Make sure both **Notify me when email arrives** is checked. Then click **Sign in**.

The screenshot shows a mobile application interface for manual setup. At the top, there is a status bar with icons for notifications, Wi-Fi, 4G, signal strength, 61% battery, and the time 4:12 PM. Below the status bar is a header with a red back arrow and the text "Manual setup". The main content area is divided into three sections by horizontal lines. The first section is titled "Period to sync Email" and contains a dropdown menu with "1 month" selected. The second section is titled "Sync schedule" and contains a dropdown menu with "Every 15 minutes" selected. The third section contains a checked checkbox and the text "Notify me when email arrives". At the bottom right of the screen, there is a button labeled "SIGN IN".

10. Fill out the optional fields as needed and click **Done**.

11:11 4G LTE 90% 9:37 AM

## Edit names

Your account has been set up. You can now change your account name and your name for outgoing email.

Account name (optional)  
testaccount@twlakes.net

Your name (for outgoing email)  
testaccount

**DONE**

**Congratulations, your Twin Lakes email is now set up on your Android device!**